

**FLASH SCALE**

MODEL	DROP	RISE	SHANK SIZE
48-00-8400	4"	5"	2"
48-00-8600	6"	7"	
48-00-8800	8"	9"	
48-00-8900	10"	11"	

**FLASH SCALE HD**

MODEL	DROP	RISE	SHANK SIZE
48-00-8625	5"	7"	2 1/2"
48-00-8825	7"	9"	
48-00-8925	9"	11"	

	MAX TONGUE WT. LB	MAX TRAILER WT. LB
<b>SCALE</b>	1,000	10,000*
<b>SCALE HD</b>	1,800	18,000*

\*2" Ball limited to 8,000 lb max trailer wt.

# FLASH™

## SCALE

## SCALE HD

Thank you for purchasing the Fastway® FLASH™ SCALE ball mount. We are happy to welcome you to our towing family. Read these instructions thoroughly to become familiar with proper set up and maintenance procedures. This will help ensure maximum performance, and years of dependable service.

Keep these instructions for future reference or access them online at [fastwaytrailer.com/manuals](http://fastwaytrailer.com/manuals).

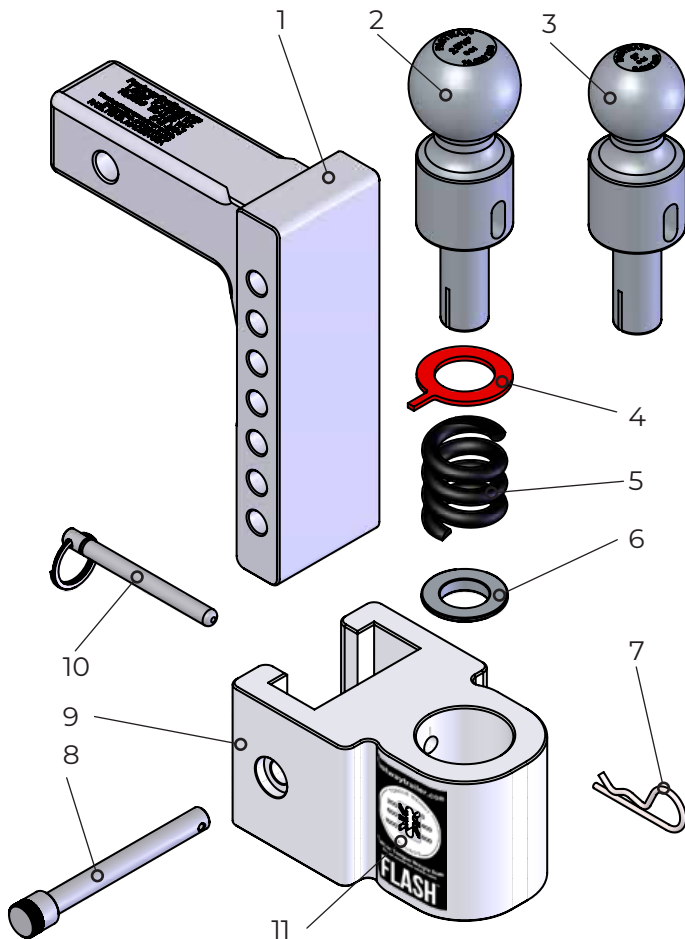

1. Drop bar
2. 2 5/16" diameter hitch ball
3. 2" diameter hitch ball
4. Indicator ring
5. Spring
6. Spring base
7. Cotter pin
8. Height adjustment pin
9. Ball holder
10. Ball retaining pin
11. Scale indicator



Locking pin set sold separately (keyed alike hitch pin and ball height adjustment pin)

SCALE: 86-00-3660  
SCALE HD: 86-00-3685

**MADE  
IN THE  
USA**

## Important Safety Information

Failure to follow all safety warnings may result in severe injury or death.

### ⚠️ WARNING

Always load the trailer correctly. Follow trailer and tow vehicle manufacturer's recommendations for placement and quantity of cargo. Tongue weight should be between 10% - 15% of Gross Trailer Weight.

Always use a hitch ball size that correctly matches your trailer coupler size and make sure it is coupled securely before towing.

Always use an appropriately sized adapter sleeve when using a tow vehicle equipped with a 2½" or 3" receiver.

It is the driver's responsibility to properly install and adjust equipment and driving habits to match towing conditions. The driver is responsible for their own safety and the safety of passengers.

Never adjust the ball holder height while the ball mount is under load from an attached trailer.

Never cut, weld, grind, bend, heat, or modify ball mount components in any way.

Never exceed the specified weight ratings for the trailer, tow vehicle, receiver hitch, ball mount, hitch ball, or any other towing equipment.

Never impact the ball mount on the ground. Do not back into things with your ball mount or attached trailer (i.e. loading docks, curb and gutter, etc.). If your ball mount has been impacted in any way, thoroughly inspect it for damage before towing, and if it is bent or damaged DO NOT tow; replace it.

Never tow your trailer until all pins and height adjustment holes have been checked for wear, visually verifying that the height adjustment pin is properly inserted through a height adjustment hole, and that the cotter pin or lock is in place.

Read, understand, and follow all safety warnings, setup, use, and maintenance instructions of your trailer, tow vehicle, and hitching equipment before installing your FLASH ball mount or towing your trailer.

### ⚠️ CAUTION

Always tow with your hitch ball adjusted to the correct height for the trailer being towed.

Never tow your trailer on excessively rough roads.

Never tow your trailer through ditches or dips where the ball mount could impact the ground.

Replace all worn, faded, or unreadable warning stickers on the ball mount immediately.

## Setting Up

1. Level the trailer by parking it on a flat surface.
2. Measure from the ground to the frame at both the front and rear of the trailer. Use the tongue jack to adjust until it is level (both front and rear measurements are the same).
3. Back the tow vehicle up to the trailer, leaving a few feet of working space between them.
4. Slide the drop bar into the tow vehicle's receiver hitch and pin it into place.
5. Measure from the ground to the bottom of the coupler on the trailer, then lock the ball holder into place on the drop bar at that height, with the correctly sized hitch ball for your trailer coupler installed. (Figure 1) You may need to invert the drop bar and use it in the rise position to reach the correct ball height for your trailer.

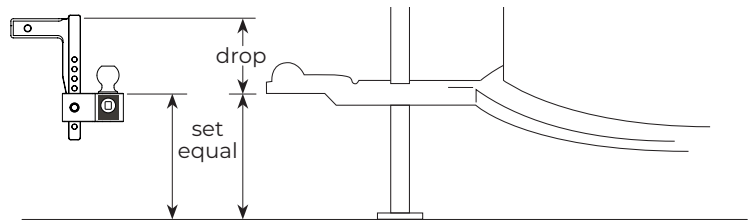

Figure 1 - With the trailer level, set the top of the ball holder at equal height to the bottom of the coupler socket.

6. Always secure the height adjustment pin with the cotter pin before placing a load on the ball mount.
7. Couple the trailer and fully retract the trailer jack.
8. Check the scale indicator to ensure the tongue weight is within the desired range, typically 10% to 15% of the gross trailer weight. Adjust the trailer loading if necessary.
9. With the trailer coupled, measure to the bottom of the coupler again, and compare the second measurement to the first. (Figure 2) The difference between these is the distance the ball mount should be adjusted upward to compensate for the drop caused by the trailer's tongue weight. (Figure 3)

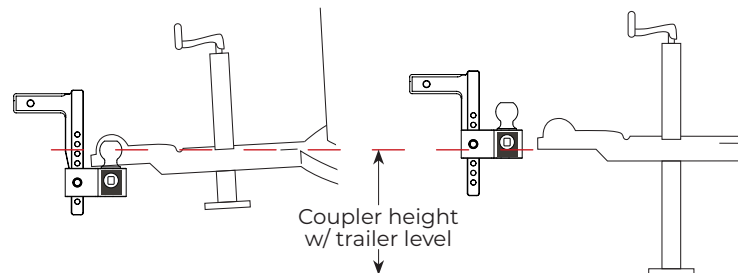
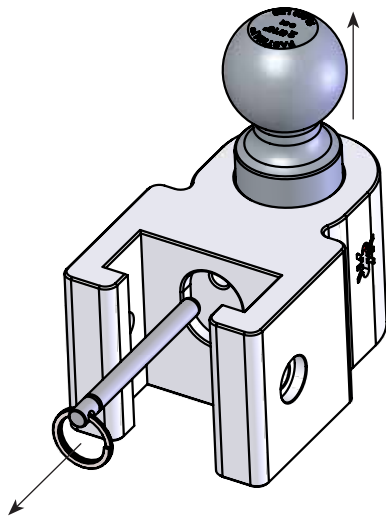

Figure 2 - Ball mount drops with added trailer tongue weight.

Figure 3 - Ball height adjusted up to compensate for drop.

10. Uncouple the trailer.
11. Raise the ball holder to the adjusted towing height, and pin it into the nearest hole. It is best to tow with the trailer as level as possible.
12. Couple the trailer and check the tongue weight again. Adjust the trailer loading to reach the desired tongue weight.
13. Repeat this process if the loading of your trailer changes, or to set the ball mount up for a different tow vehicle and/or trailer.



**Figure 4** - Use the ring to remove the ball retaining pin.

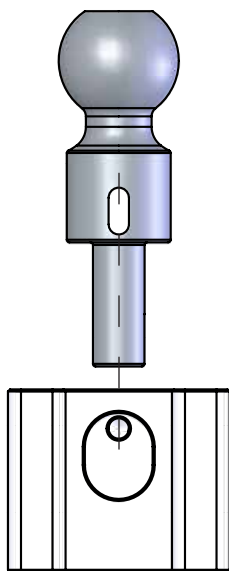

**Figure 5** - Align the slot with the pin hole.

## Switching Hitch Ball Sizes

To switch hitch ball sizes, uncouple the trailer, and remove the ball holder from the drop bar. Use the attached ring on the retaining pin to remove it. Remove the hitch ball and replace it with the ball sized to match your trailer's coupler. (Figure 4)

Align the retaining slot in the base of the ball with the holes for the retaining pin. (Figure 5) Replace the pin. The pin must be inserted completely to be able to install the ball holder on the drop bar. Slide the ball holder into the correct position on the drop bar, and pin it into place.

## Reading the Scale

The FLASH SCALE and SCALE HD measure tongue weights from 0 to 1,800 lbs. depending on your model. If the tongue weight indicator is past the 1,000 lb mark (for the SCALE) or 1,800 lb mark (for the SCALE HD), you have exceeded the maximum rating of the ball mount.

**Do not exceed the maximum tongue weight rating.**

The FLASH SCALE has indication marks at 0 (zero), 200, 400, 600, 800 and 1,000 lb. (Figure 6)

The FLASH SCALE HD has indication marks at 0 (zero), 300, 600, 900, 1,200, 1,500 and 1,800 lb. (Figure 7)

These weights are shown when the indicator is centered on these marks.

The SCALE and SCALE HD have a tolerance of +/-10%.

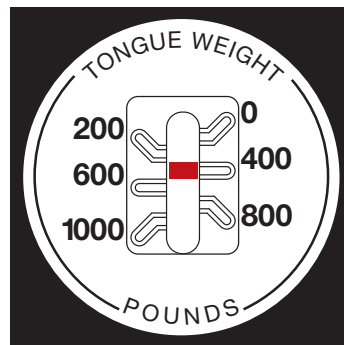

**Figure 6** - FLASH SCALE indicates a tongue weight of 400 lb.

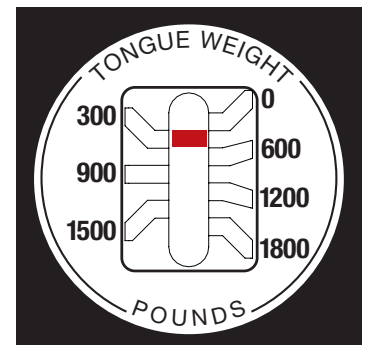

**Figure 7** - FLASH SCALE HD indicates a tongue weight of 450 lb.

## Stow-Away Feature

---

The SCALE ball mount can rotate under the truck bumper when not in use, protecting your shins and avoiding impact with anything when in reverse.

The following models of the SCALE ball mount have Stow-Away capability with most vehicles:

- 8" Standard, and HD Models
- 10" Standard, and HD Models

## Care and Maintenance

---

### Clean

Regularly (at least monthly) remove your ball mount from the receiver and wipe away any moisture and road grime from the pins and the inside of the pin hole. Keep a thin film of grease on the pins; doing so will help prevent corrosion, which could cause them to become stuck.

Wipe away dirt and grime with a soft cloth. When cleaning the drop bar and ball holder surfaces, DO NOT use a degreaser or harsh cleaners - mild soap and water is best for aluminum.

Disassemble and wipe the internal parts (ball, indicator ring, spring, spring base) clean with a cloth. Clean any dirt or debris from the inside of the scale housing with mild soap and water. DO NOT grease the spring components.

If you live in an area where salt and sand are used during winter to treat roadways, remove your FLASH ball mount and store it inside the tow vehicle, instead of in the receiver during winter months. These elements are extremely abrasive and can damage the hand-polished finish of your ball mount.

### Lubricate

Always lubricate the hitch ball with heavy, multi-purpose grease or wheel bearing grease.

### Polish

Maintain the shine of the ball mount by using aluminum wheel cleaner and applying an automobile wax to protect the finish.

## Limited 1 Year Warranty

---

Do not return this product to the retailer.

For warranty claims or customer support contact Fastway Trailer Products directly weekdays 8:00 AM - 5:00 PM Mountain Time at (877)523-9103 or by email at [support@fastwaytrailer.com](mailto:support@fastwaytrailer.com)

Fastway Trailer Products warrants the FLASH SCALE, excluding chrome and corrosion, against latent defects in materials and workmanship under normal use and service, ordinary wear and tear is excepted, to the original owner for a period of 1 year from the first date of purchase at retail up to the value of its original purchase price. If this product is latently defective it will be replaced or repaired when a proper return authorization is obtained and the product is returned with transportation charges prepaid to Fastway Trailer Products. Fastway Trailer Products shall not be required to replace or repair any products damaged as a result of improper installation, alteration, unreasonable use, or improper maintenance including, without limitation, loading the product beyond the factory rated load capacity. This warranty does not include labor charges nor does it include transportation charges for returning the product to the consumer. To the extent allowed by law, Fastway Trailer Products shall not be liable for any incidental, consequential, or any other damages including, without limitation, breach of any implied warranty, merchantability, or fitness for a particular purpose of any Fastway product. In no event shall Fastway Trailer Products be liable for any damages other than the replacement or repair of the affected part. Authorization and warranty procedure may be obtained by calling Fastway Trailer Products customer support at (877)523-9103.

Visit our YouTube channel for a detailed video of the FLASH SCALE.

 [youtube.com/fastwaytrailer](https://www.youtube.com/fastwaytrailer)

 [facebook.com/fastwaytrailer](https://www.facebook.com/fastwaytrailer)

 [X.com/fastwaytrailer](https://www.x.com/fastwaytrailer)

 [instagram.com/fastwaytrailer](https://www.instagram.com/fastwaytrailer)